

GENERAL DESCRIPTION

INTAKE (INDUCTION)

1. General Description

A: COMPONENT

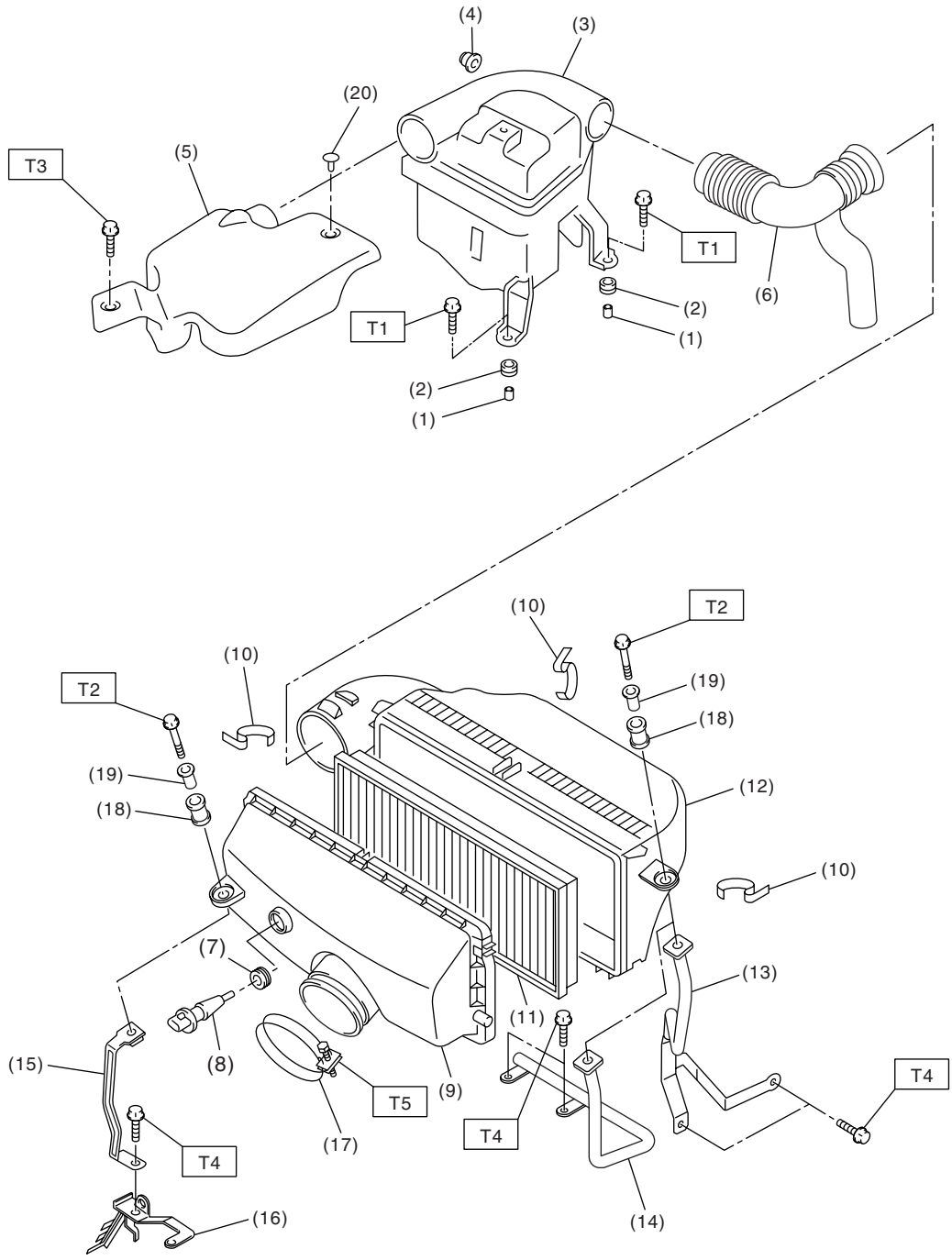

IN-00038

GENERAL DESCRIPTION

INTAKE (INDUCTION)

(1) Spacer	(10) Clip	(19) Spacer
(2) Bush	(11) Air cleaner element	(20) Clip
(3) Resonator chamber	(12) Air cleaner case B	
(4) Cushion	(13) Stay LH (MT model)	
(5) Air intake duct A	(14) Stay LH (AT model)	
(6) Air intake duct B	(15) Stay RH	
(7) Clamp	(16) Engine harness bracket	
(8) Intake air temperature sensor	(17) Clamp	
(9) Air cleaner case A	(18) Bush	

Tightening torque: N·m (kgf·m, ft·lb)

T1: 33 (3.4, 24.6)

T2: 6.5 (0.66, 4.8)

T3: 7.5 (0.76, 5.5)

T4: 16 (1.6, 11.6)

T5: 3 (0.3, 2.2)

GENERAL DESCRIPTION

INTAKE (INDUCTION)

B: CAUTION

- Wear working clothing, including a cap, protective goggles, and protective shoes during operation.
- Remove contamination including dirt and corrosion before removal, installation or disassembly.
- Keep the disassembled parts in order and protect them from dust or dirt.
- Before removal, installation or disassembly, be sure to clarify the failure. Avoid unnecessary removal, installation, disassembly, and replacement.
- Be careful not to burn your hands, because each part on the vehicle is hot after running.
- Be sure to tighten fasteners including bolts and nuts to the specified torque.
- Place shop jacks or safety stands at the specified points.
- Before disconnecting electrical connectors of sensor or units, be sure to disconnect the ground cable from battery.