

REAR DRUM BRAKE SHOE

BRAKE

8. Rear Drum Brake Shoe

A: REMOVAL

- 1) Set the vehicle on a lift.
- 2) Loosen the wheel nuts.
- 3) Lift-up the vehicle, and then remove the wheels.
- 4) Release the parking brake.
- 5) Remove the brake drum from brake assembly.

NOTE:

- If it is difficult to remove the brake drum, remove the adjusting hole cover from back plate, and then turn adjuster assembly pawls using a flat tip screwdriver until brake shoe separates from the drum.

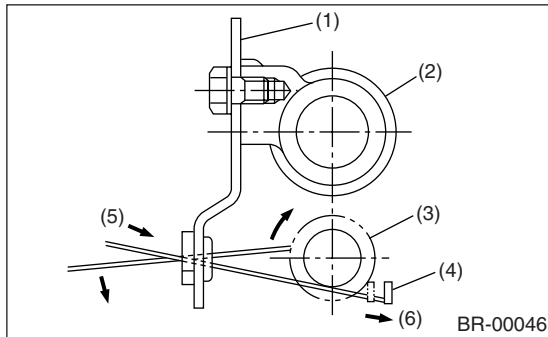

- (1) Back plate
- (2) Wheel cylinder
- (3) Adjuster ASSY pawls
- (4) Adjusting lever
- (5) Tightening direction
- (6) Push

- If the brake drum is difficult to remove, drive it out by installing an 8 mm bolt into bolt hole in brake drum.

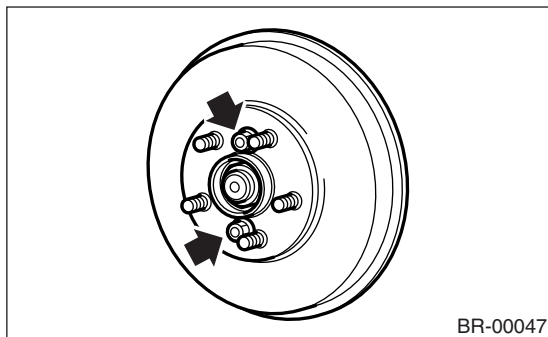

- 6) Hold the hold-down pin by securing rear of back plate with your hand.

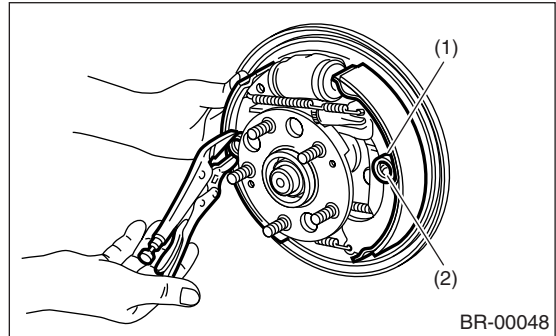

- (1) Hold-down cup
- (2) Hold-down pin

- 7) Disconnect the hold-down cup from hold-down pin by rotating hold-down cup.
- 8) Disconnect the lower shoe return spring from shoes.

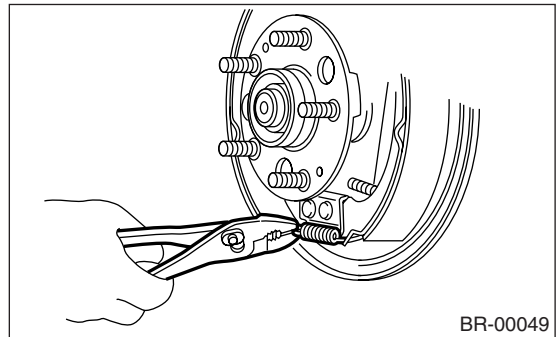

- 9) Remove the shoes one by one from back plate with adjuster.

CAUTION:

Be careful not to bend the parking brake cable excessively when removing brake shoes.

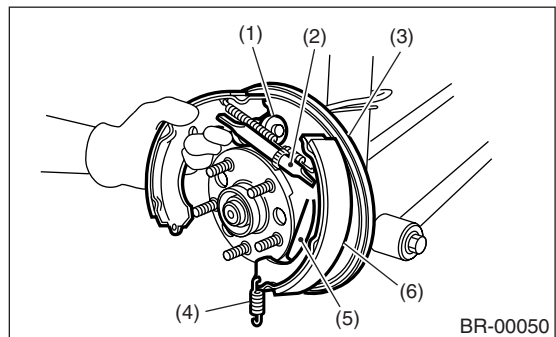

- (1) Wheel cylinder
- (2) Adjuster
- (3) Back plate
- (4) Lower shoe return spring
- (5) Parking lever
- (6) Trailing shoe

10) Disconnect the parking brake cable from parking lever.

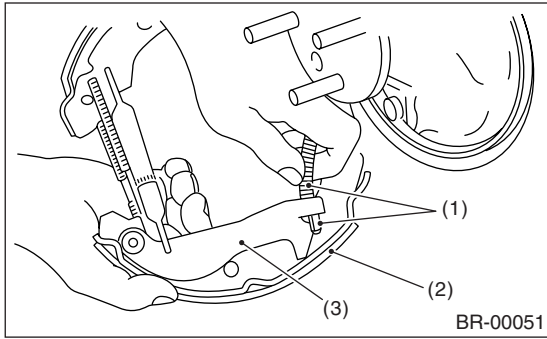

- (1) Parking brake cable
- (2) Trailing shoe
- (3) Parking brake lever

11) Remove the upper shoe return spring and adjusting spring from brake shoe.

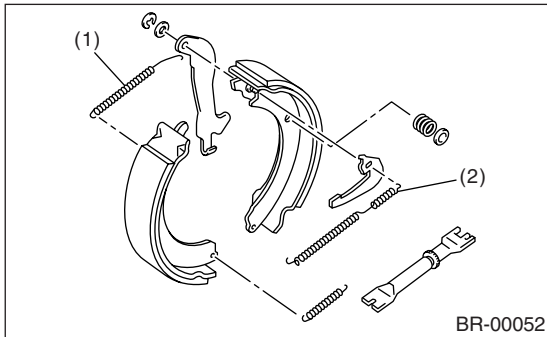

- (1) Upper shoe return spring
- (2) Adjusting spring

B: INSTALLATION

- 1) Clean the back plate and wheel cylinder.
- 2) Apply grease to portions indicated by arrows in the figure.

Brake grease:

Dow Corning Molykote No. 7439 (Part No. 003602001)

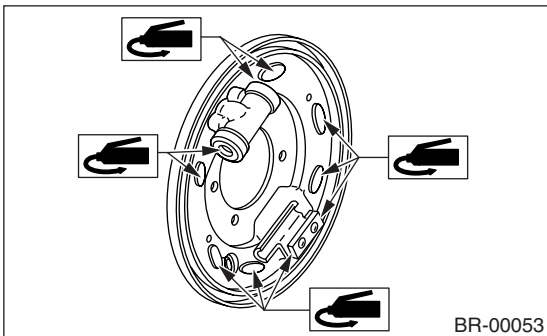

3) Apply grease to the adjusting screw and both ends of adjuster.

Brake grease:

Dow Corning Molykote No. 7439 (Part No. 003602001)

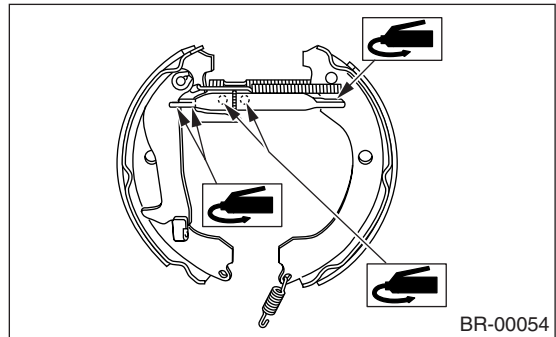

- 4) Connect the upper shoe return spring to shoes.
- 5) Connect the parking brake cable to parking lever.
- 6) While positioning the shoes (one at a time) in groove on wheel cylinder, secure the shoes.

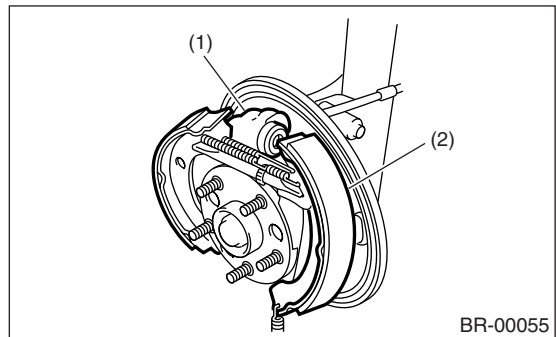

- (1) Wheel cylinder
- (2) Shoe (Trailing)

- 7) Fix the shoes by connecting hold-down cup to hold-down pin.
- 8) Connect the lower shoe return spring.
- 9) Set the outside diameter of brake shoes less than 0.5 to 0.8 mm (0.020 to 0.031 in) in comparison with inside diameter of brake drum.

C: INSPECTION

1) Measure the lining thickness. If the thickness of lining is outside the service limit, replace the shoes.

Lining thickness:

Standard 4.1 mm (0.161 in)

Service limit 1.5 mm (0.059 in)

- 2) If the deformation or wear of back plate, shoe, etc. are notable, replace them.
- 3) When the shoe return spring tension is excessively weakened, replace it, taking care to identify the upper and lower springs.