

4. Rear Seat Belt

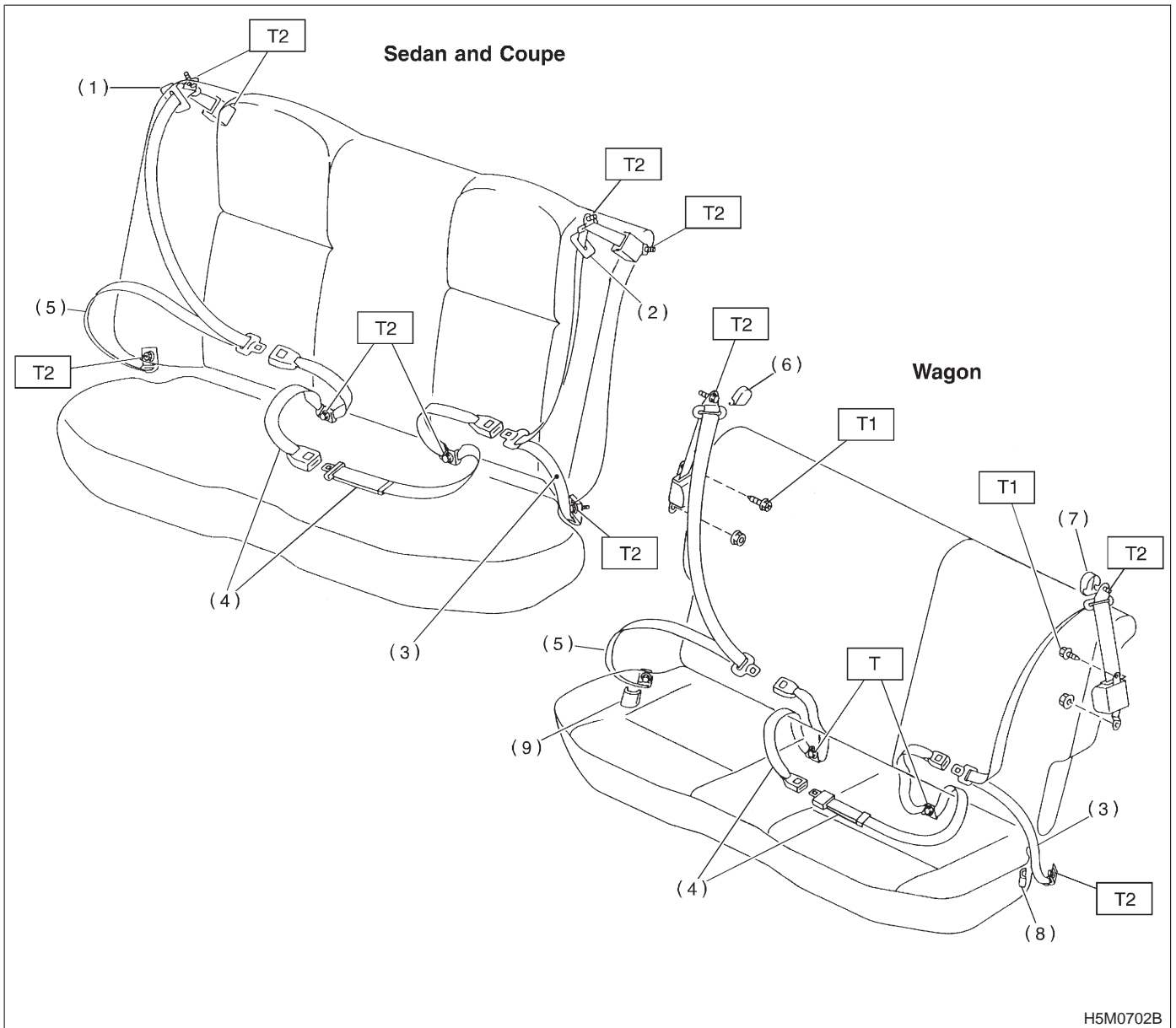

H5M0702B

- | | |
|--------------------------|---------------------------|
| (1) Webbing cover (RH) | (6) Through cap (RH) |
| (2) Webbing cover (LH) | (7) Through cap (LH) |
| (3) Outer seat belt (LH) | (8) Lap anchor cover (LH) |
| (4) Center seat belt | (9) Lap anchor cover (RH) |
| (5) Outer seat belt (RH) | |

Tightening torque: N-m (kg-m, ft-lb)

T1: 13±3 (1.3±0.3, 9.4±2.2)

T2: 35±13 (3.6±1.3, 26±9)