

8. Main Fuel Level Sensor

A: REMOVAL

- 1) Release fuel pressure. <Ref. to 2-8 [W1B0].>
- 2) Open fuel flap lid, and remove fuel filler cap.

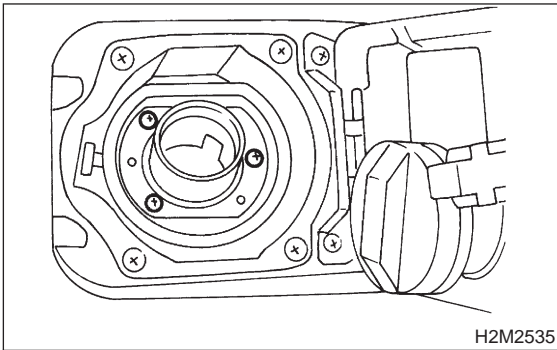

- 3) Disconnect battery ground cable.

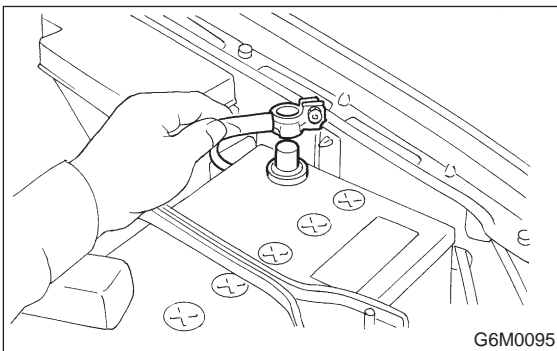

- 4) Disconnect connector from fuel pump.

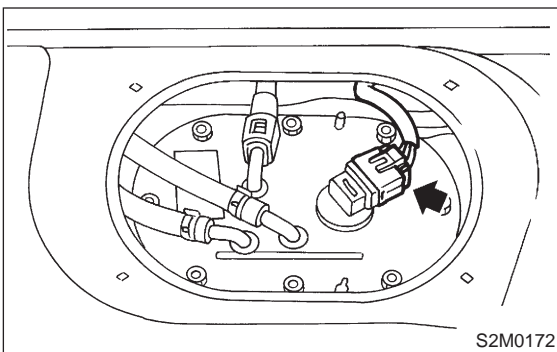

- 5) Move clips, and then disconnect fuel delivery hose (A).
- 6) Disconnect quick connector, and then disconnect fuel delivery hose (A). <Ref. to 2-8 [W7A0].>

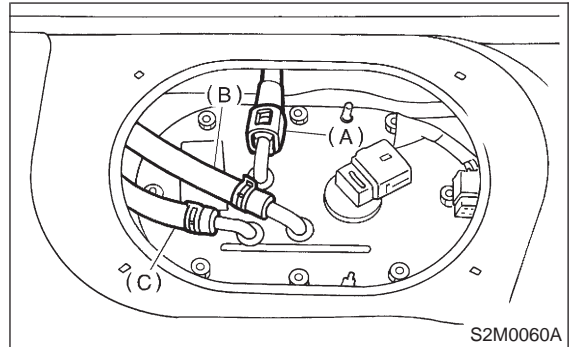

- 7) Remove nuts which install fuel pump assembly onto fuel tank.

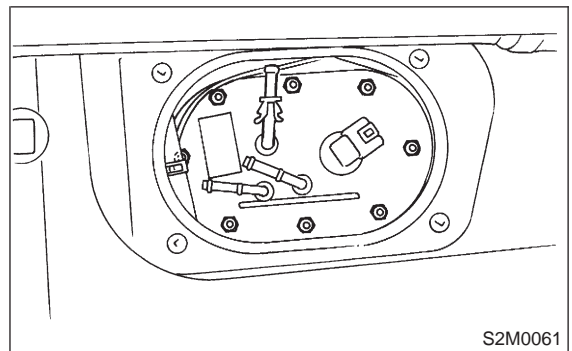

- 8) Take off fuel pump assembly from fuel tank.
- 9) Disconnect connector from fuel pump bracket.

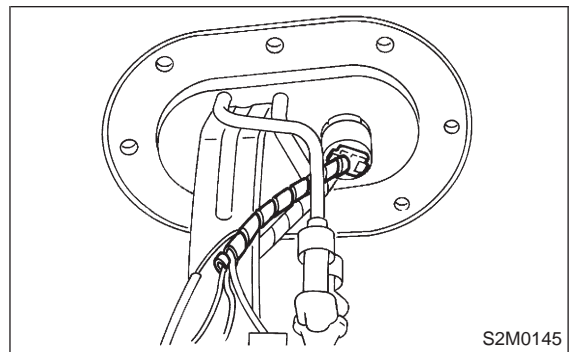

- 10) Remove bolt which installs fuel level sensor on mounting bracket.

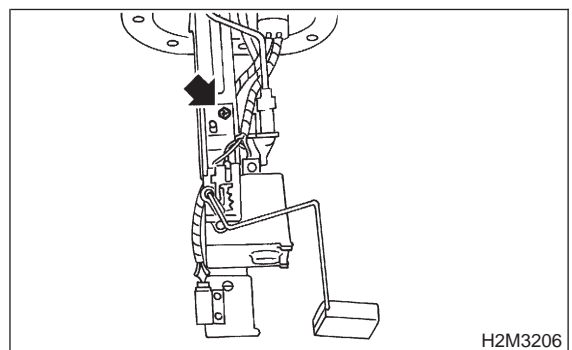

B: INSTALLATION

CAUTION:

Leave fuel filler cap open when tightening nuts, to prevent fuel from flowing out through fuel delivery and return pipes. Close fuel filler cap after tightening nuts.

Installation is in the reverse order of removal. Do the following:

- 1) Install the fuel level sensor onto the mounting bracket.

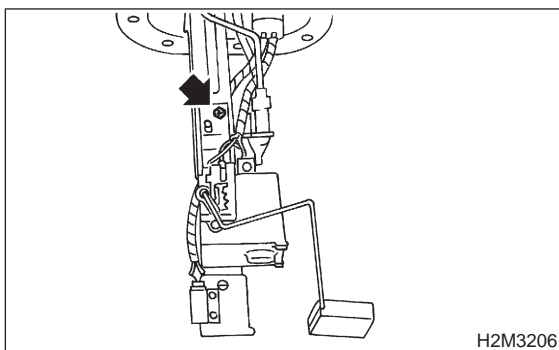

- 2) Always use new gaskets.
- 3) Ensure sealing portion is free from fuel or foreign particles before installation.
- 4) Tighten nuts in alphabetical sequence shown in figure to specified torque.

Tightening torque:

$4.4 \pm 1.5 \text{ N}\cdot\text{m}$ ($0.45 \pm 0.15 \text{ kg}\cdot\text{m}$, $3.3 \pm 1.1 \text{ ft}\cdot\text{lb}$)

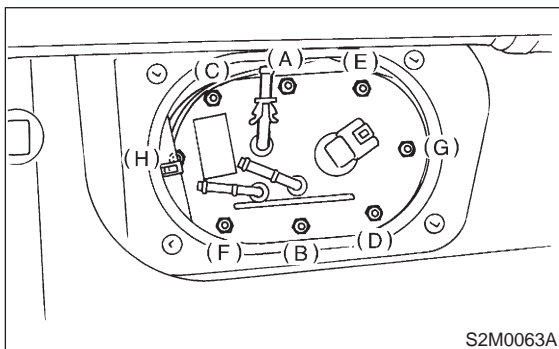

9. Air Filter

A: REMOVAL AND INSTALLATION

- 1) Disconnect battery ground cable.

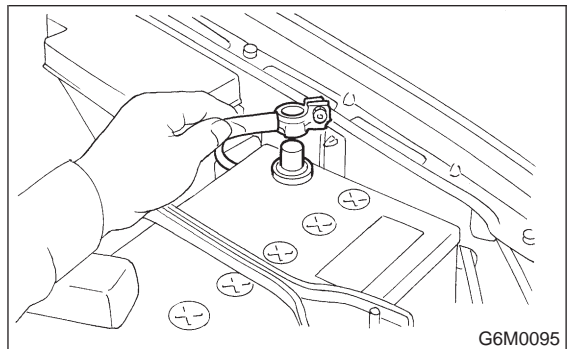

- 2) Lift-up the vehicle.
- 3) Remove canister. <Ref. to 2-1 [W3A0].>

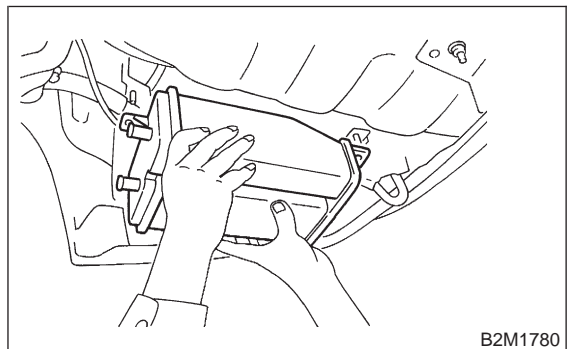

- 4) Disconnect connector from drain valve.

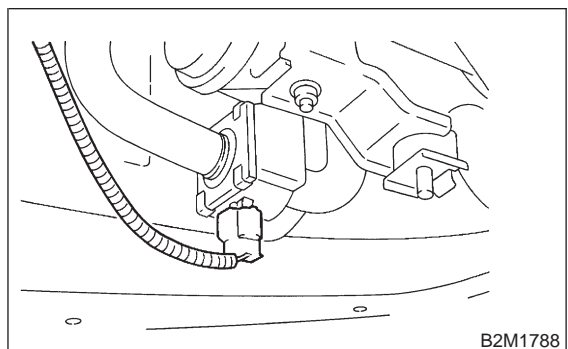

- 5) Disconnect evaporation hoses (A) from joint pipes.

