

6. Radiator Main Fan and Fan Motor

A: REMOVAL AND INSTALLATION

- 1) Disconnect battery ground cable.

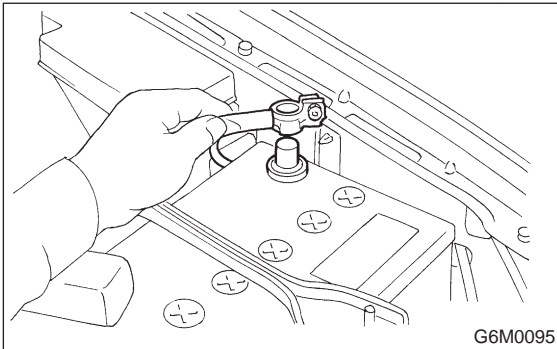

- 2) Lift-up the vehicle.
- 3) Remove under cover.

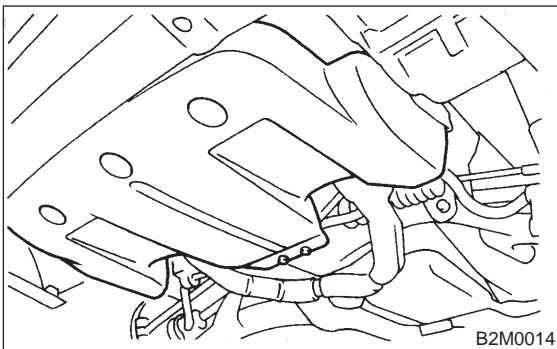

- 4) Disconnect connector of main fan motor.

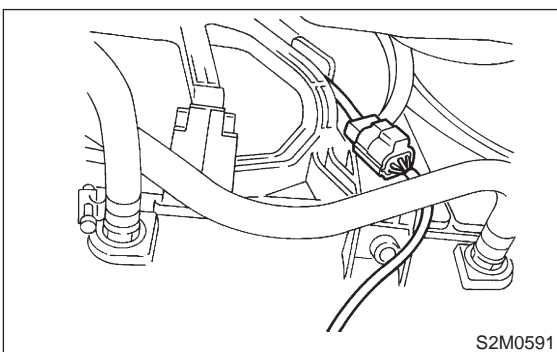

- 5) Detach ATF cooler hose attached to 2 clips under the radiator main fan shroud.

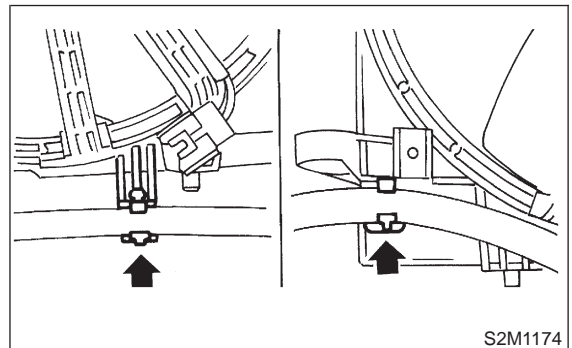

- 6) Lower the vehicle.
- 7) Remove V-belt covers.

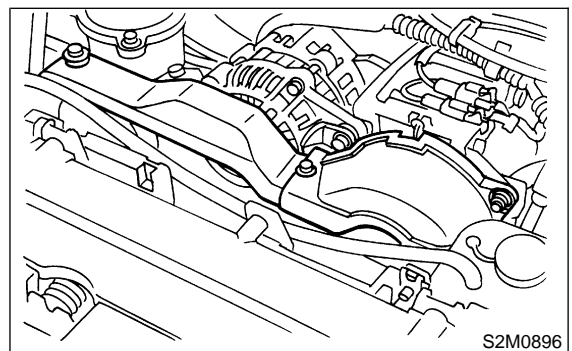

- 8) Disconnect over flow hose.

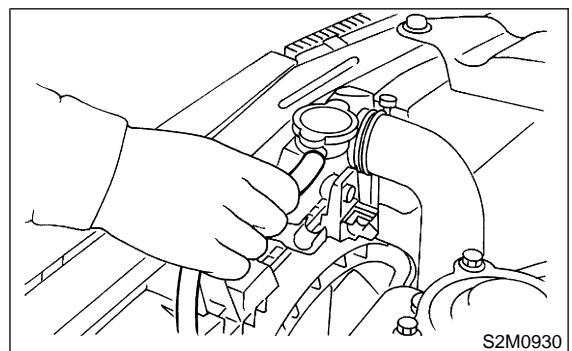

- 9) Remove reservoir tank.

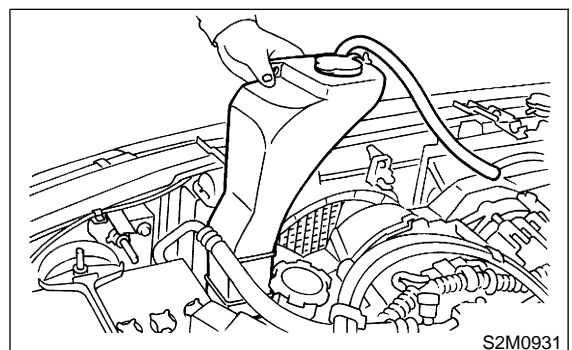

10) Remove radiator main fan motor assembly.

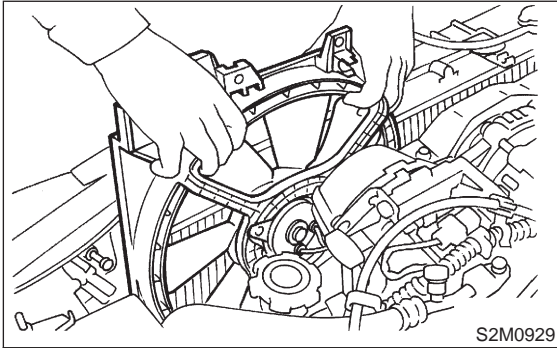

11) Installation is in the reverse order of removal.

NOTE:

When the main fan motor assembly cannot be installed as is, loosen the sub fan motor assembly securing bolts to install it. <Ref. to 2-5 [W7A0].>

Tightening torque:

4.9±1.5 N·m (0.50±0.15 kg·m, 3.6±1.1 ft·lb)

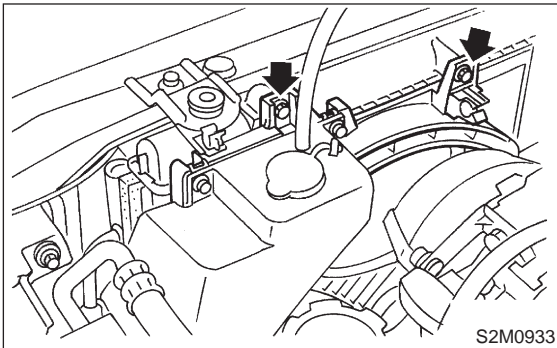

Tightening torque:

4.9±1.5 N·m (0.50±0.15 kg·m, 3.6±1.1 ft·lb)

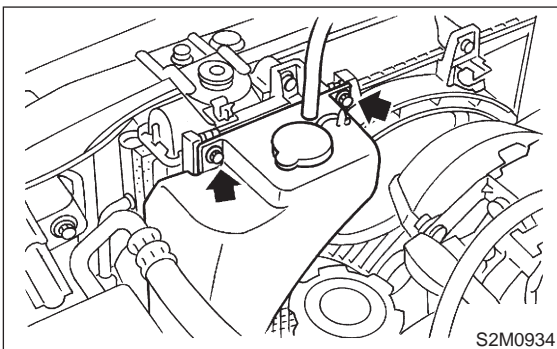

B: DISASSEMBLY AND ASSEMBLY

1) Remove clip which holds motor connector onto shroud.

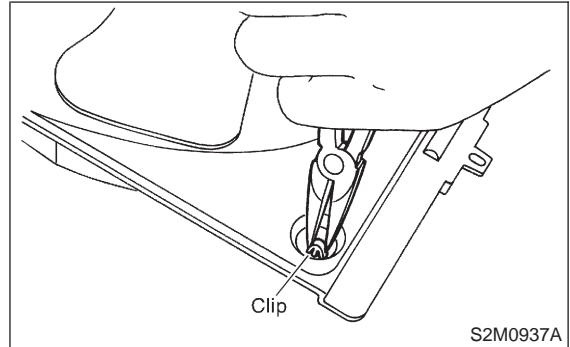

2) Remove bolt which install fan itself onto fan motor and shroud assembly.

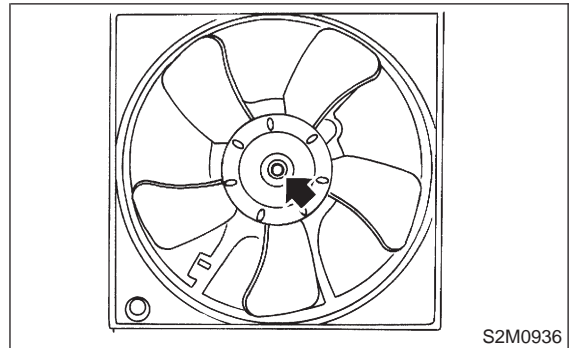

3) Remove bolts which install fan motor onto shroud.

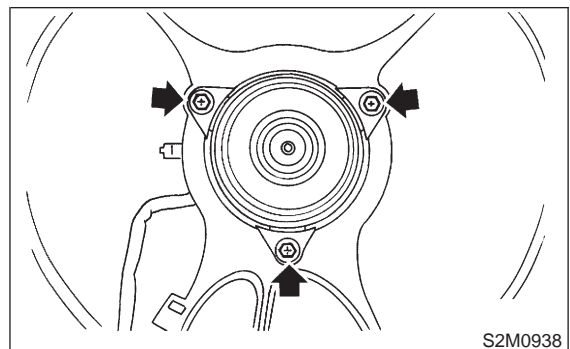

4) Installation is in the reverse order of removal.

Tightening torque:

$4.4 \pm 0.5 \text{ N}\cdot\text{m}$ ($0.45 \pm 0.05 \text{ kg}\cdot\text{m}$, $3.3 \pm 0.4 \text{ ft}\cdot\text{lb}$)

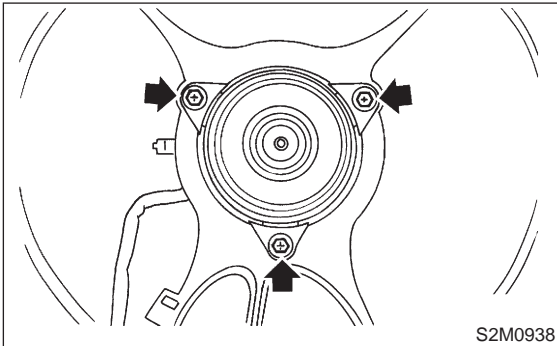

Tightening torque:

$3.4 \pm 0.5 \text{ N}\cdot\text{m}$ ($0.35 \pm 0.05 \text{ kg}\cdot\text{m}$, $2.5 \pm 0.4 \text{ ft}\cdot\text{lb}$)

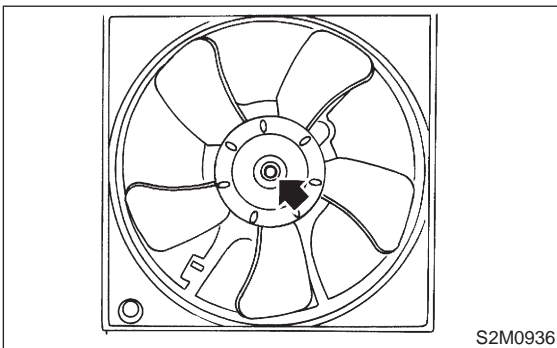

7. Radiator Sub Fan and Fan Motor

A: REMOVAL AND INSTALLATION

1) Disconnect battery ground cable.

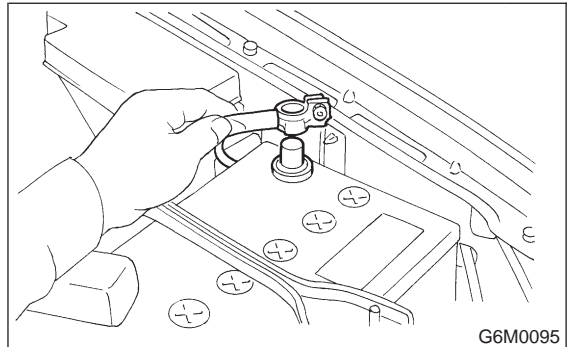

2) Lift-up the vehicle.
3) Remove under cover.

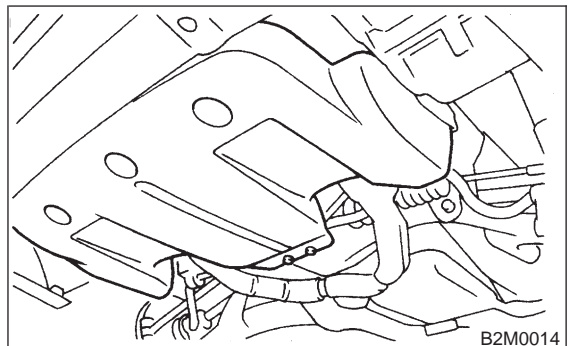

4) Disconnect connector of sub fan motor.

