

2. EXCEPT 2200 cc CALIFORNIA SPEC. VEHICLES

- 1) Disconnect battery ground cable.

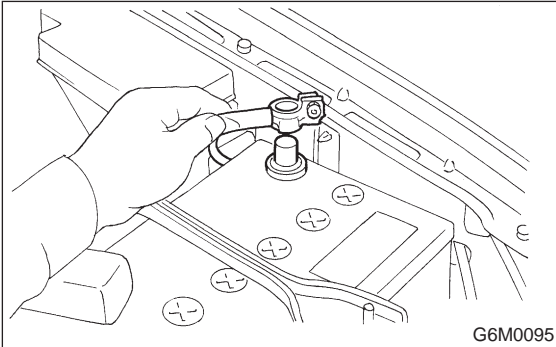

- 2) Disconnect connector from mass air flow sensor.

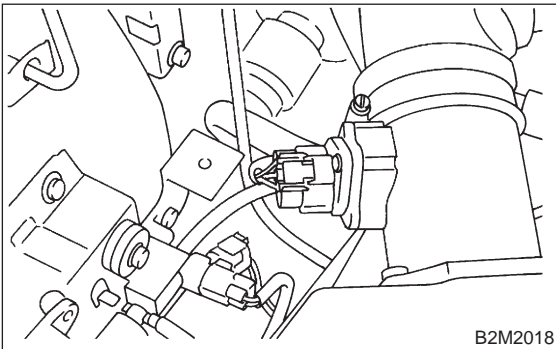

- 3) Loosen clamp which connects air intake duct to air intake chamber.

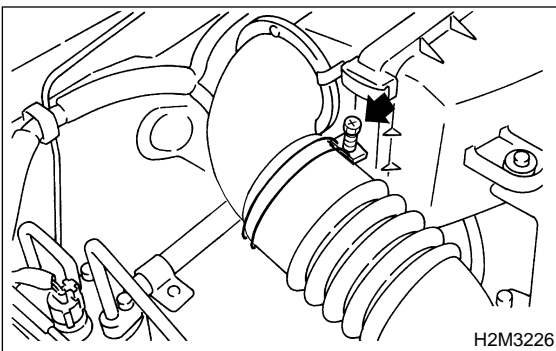

- 4) Remove two clips of air cleaner upper cover.

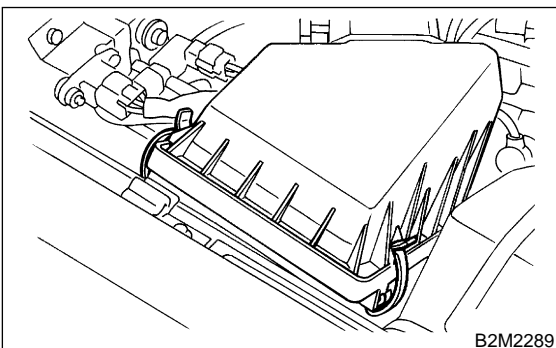

**6. Crankshaft Position Sensor
A: REMOVAL AND INSTALLATION**

- 1) Disconnect battery ground cable.

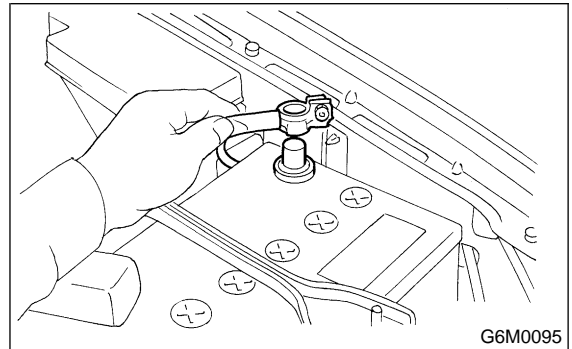

- 2) Remove bolt which install crankshaft position sensor to cylinder block.

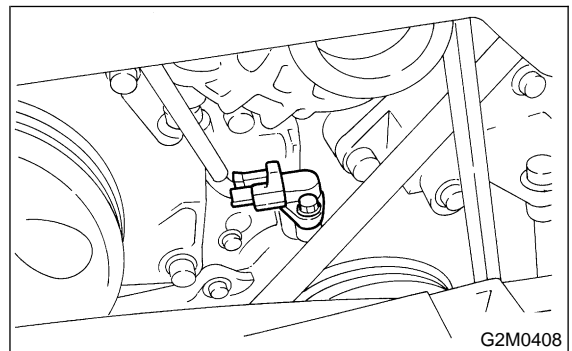

- 3) Remove crankshaft position sensor, and disconnect connector from it.

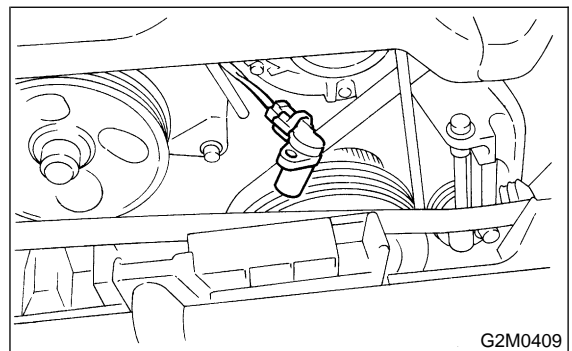

4) Installation is in the reverse order of removal.

Tightening torque:

$6.4 \pm 0.5 \text{ N}\cdot\text{m}$ ($0.65 \pm 0.05 \text{ kg}\cdot\text{m}$, $4.7 \pm 0.4 \text{ ft}\cdot\text{lb}$)

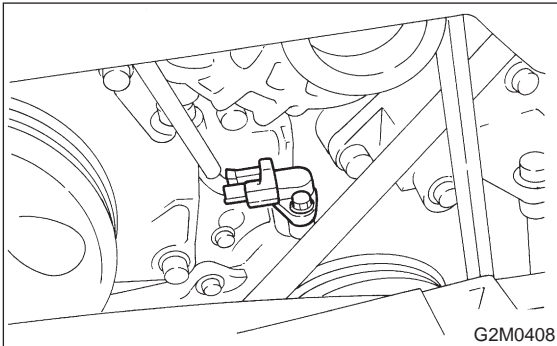

7. Front Oxygen (A/F) Sensor

A: REMOVAL

1) Disconnect battery ground cable.

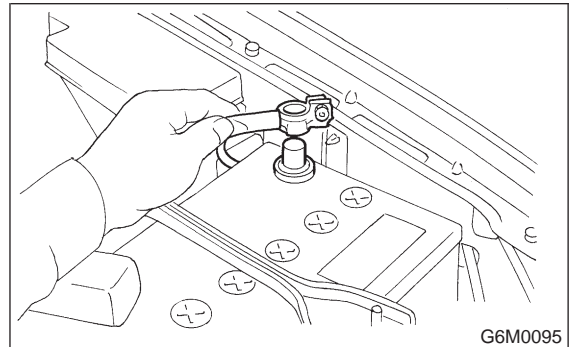

2) Disconnect connector from front oxygen sensor.

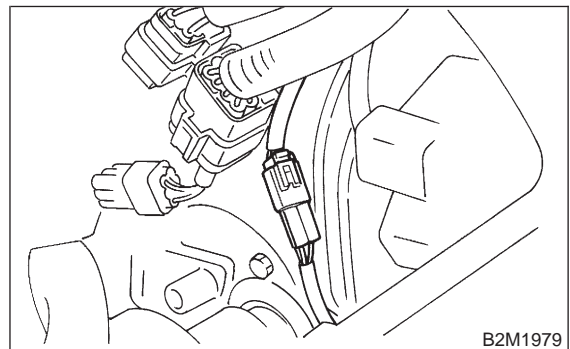

3) Lift-up the vehicle.

4) Apply SUBARU CRC or its equivalent to threaded portion of front oxygen (A/F) sensor, and leave it for one minute or more.

SUBARU CRC (Part No. 004301003)

5) Remove front oxygen (A/F) sensor.

CAUTION:

When removing, do not force front oxygen (A/F) sensor in an unnatural way especially when exhaust pipe is cold, otherwise it will damage exhaust pipe.

