

19. Knock Sensor

A: REMOVAL

1) Disconnect battery ground cable from battery ground terminal.

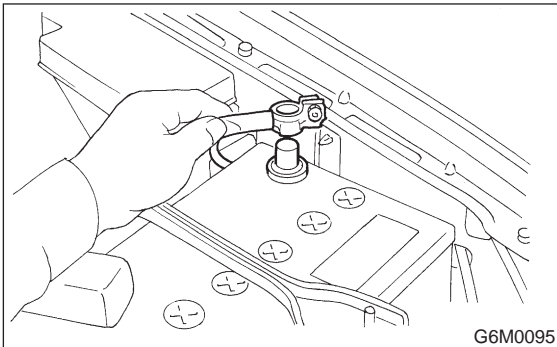

2) Remove air cleaner assembly.
(2200 cc California spec. vehicles only)
<Ref. to 2-7 [W1A0].>

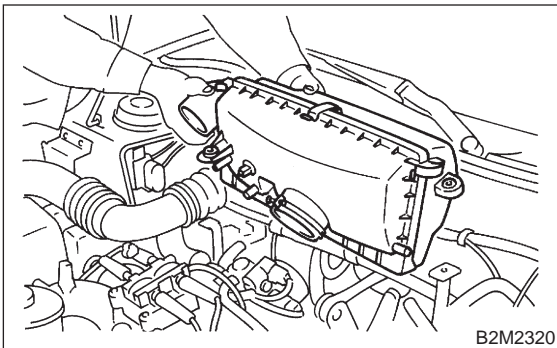

3) Remove air intake chamber.
(Except 2200 cc California spec. vehicles)
<Ref. to 2-7 [W18A0].>

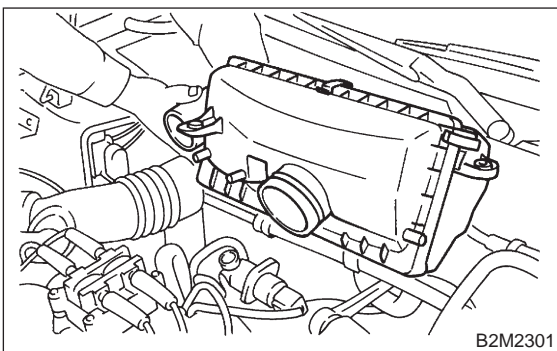

4) Remove band which holds knock sensor harness, and disconnect connector from knock sensor.

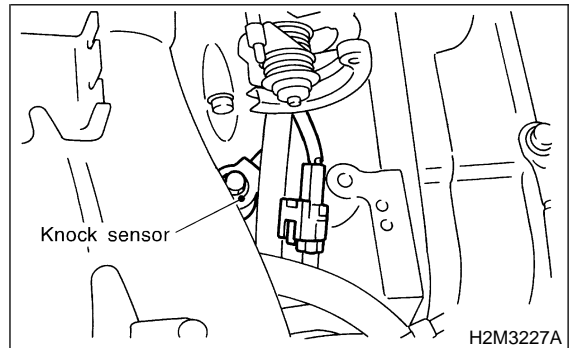

5) Remove knock sensor from cylinder block.

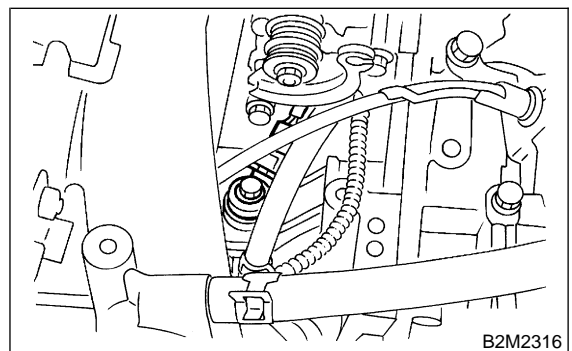

B: INSTALLATION

1) Install knock sensor to cylinder block.

Tightening torque:

23.5 ± 2.9 N-m (2.4 ± 0.3 kg-m, 17.4 ± 2.2 ft-lb)

NOTE:

The knock sensor cord which is extracted from the sensor must be positioned at a 45° angle against the rear side of the engine.

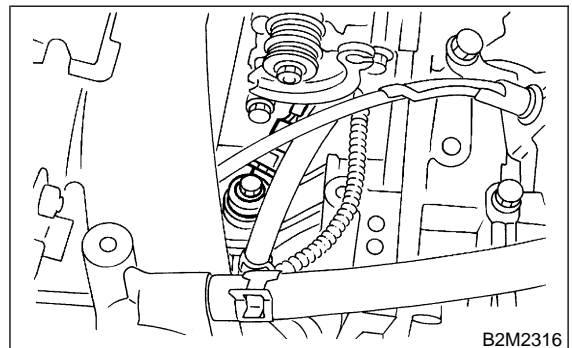

2-7 [W20A0]

SERVICE PROCEDURE

20. Intake Manifold Pressure Sensor (2200 cc California Spec. Vehicles only)

- 2) Connect knock sensor connector and hold knock sensor harness with band.
- 3) Install air intake chamber. (Except California spec. vehicles) <Ref. to 2-7 [W18A0].>

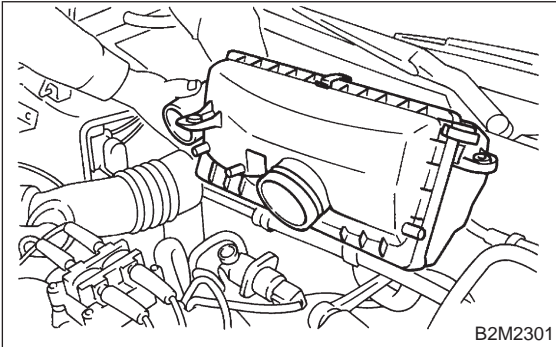

- 4) Install air cleaner assembly. (California spec. vehicles only) <Ref. to 2-7 [W1A0].>

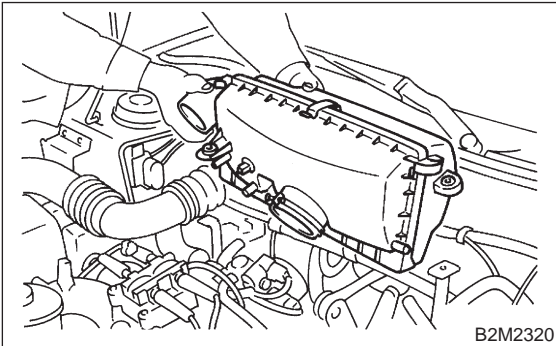

- 5) Connect battery ground cable to battery ground terminal.

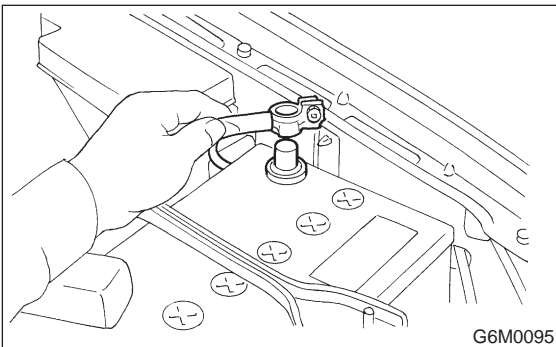

20. Intake Manifold Pressure Sensor (2200 cc California Spec. Vehicles only)

A: REMOVAL AND INSTALLATION

- 1) Disconnect battery ground cable.

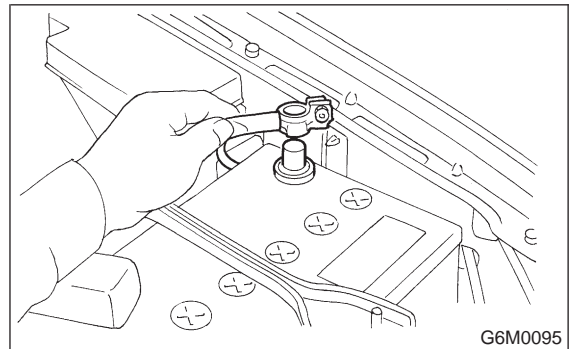

- 2) Remove idle air control solenoid valve. <Ref. to 2-7 [W12A1].>

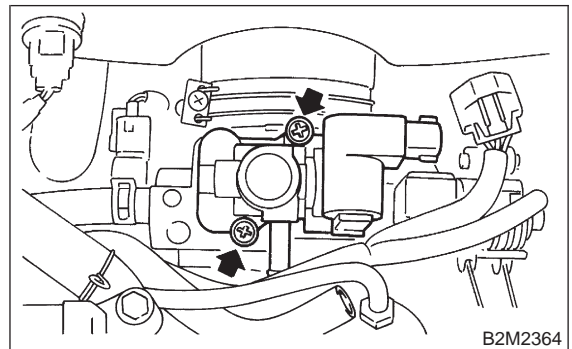

- 3) Disconnect connector from intake manifold pressure sensor.

