

## C: INSTALLATION

### CAUTION:

- If fuel hoses are damaged at the connecting portion, replace it with a new one.
- If clamps are badly damaged, replace with new ones.

- 1) Installation is in the reverse order of removal.
- 2) Tighten hose clamp screws.

### Tightening torque:

$1.0^{+0.5}/_{-0}$  N·m ( $0.1^{+0.05}/_{-0}$  kg·m,  $0.7^{+0.4}/_{-0}$  ft·lb)

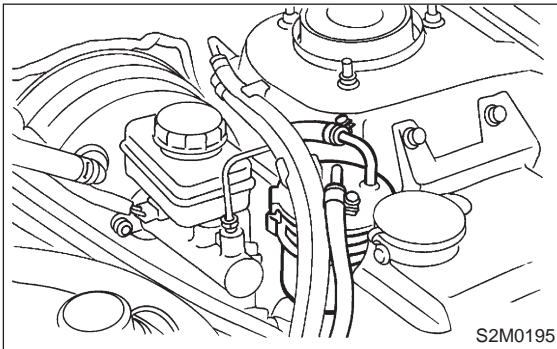

## 5. Fuel Pump

### A: REMOVAL

- 1) Release fuel pressure. <Ref. to 2-8 [W1B0].>
- 2) Open fuel flap lid, and remove fuel filler cap.

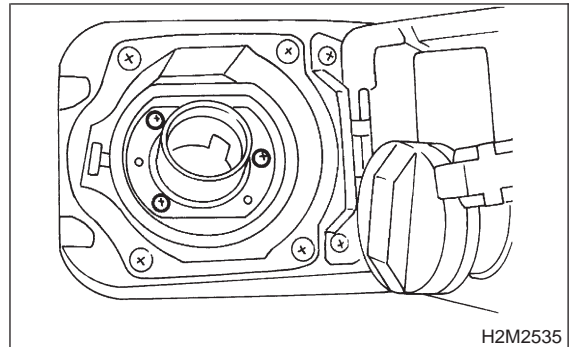

- 3) Disconnect battery ground cable.

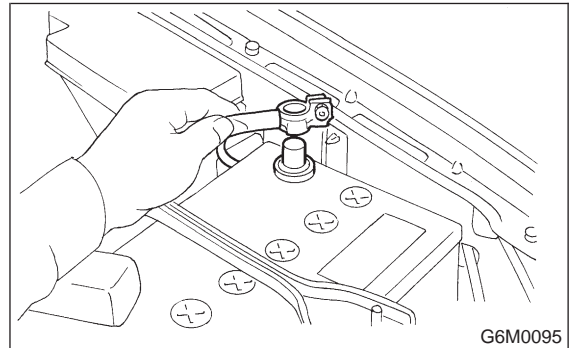

- 4) Disconnect connector from fuel pump.

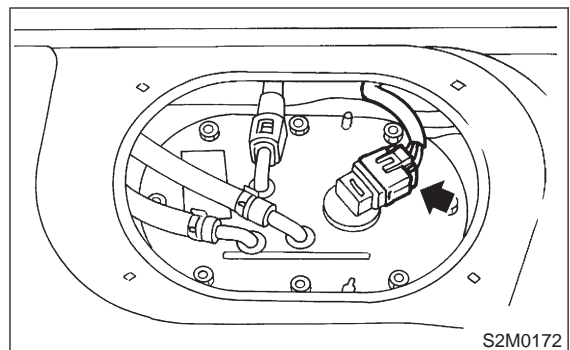

- 5) Move clips, and then disconnect fuel delivery hose (A), return hose (B) and jet pump hose (C).

6) Disconnect quick connector, and then disconnect fuel delivery hose (A). <Ref. to 2-8 [W7A0].>

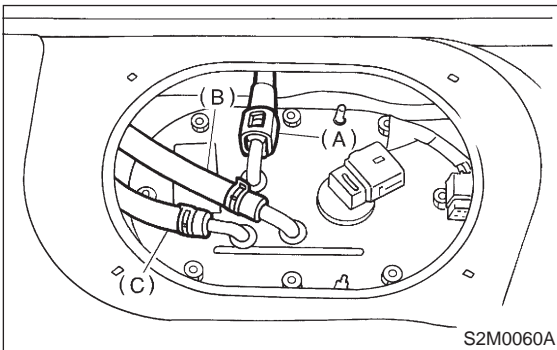

7) Remove nuts which install fuel pump assembly onto fuel tank.  
8) Take off fuel pump from fuel tank.

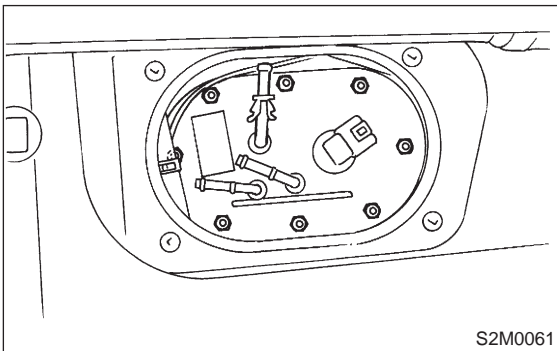

- (1) Always use new gaskets.
- (2) Ensure sealing portion is free from fuel or foreign particles before installation.
- (3) Tighten nuts in numerical sequence shown in Figure to specified torque.

**Tightening torque:**  
 **$4.4 \pm 1.5 \text{ N}\cdot\text{m}$  ( $0.45 \pm 0.15 \text{ kg}\cdot\text{m}$ ,  $3.3 \pm 1.1 \text{ ft}\cdot\text{lb}$ )**

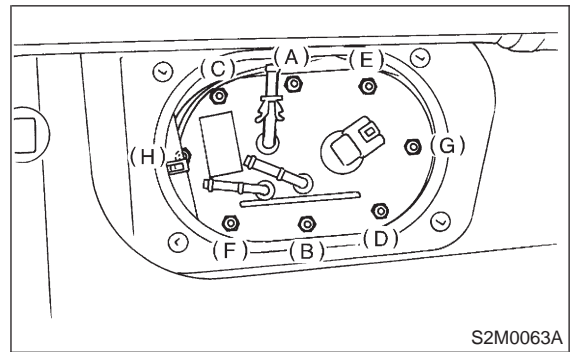

## B: INSPECTION

Connect lead harness to connector terminal of fuel pump, and apply battery power supply to check whether the pump operate.

### WARNING:

- Wipe off the fuel completely.
- Be sure to turn the battery supply ON and OFF on the battery side.
- Do not run fuel pump for a long time under non-load condition.

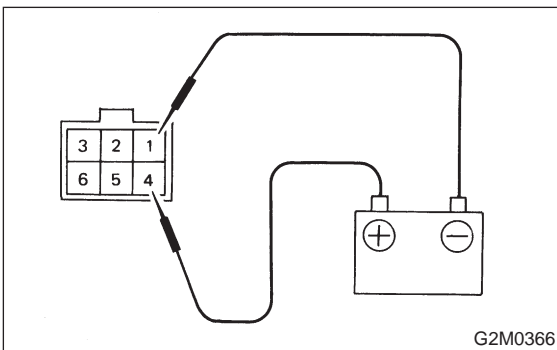

## C: INSTALLATION

Installation is in the reverse order of removal. Do the following: