

4) Remove high-pressure hose:

CAUTION:

With the following cautions, replace flexible hoses with new ones if they are damaged or swollen.

- The flexible hoses should be free from twists and tension after they have been connected.
- The flexible hoses must not be bent or twisted forcibly.

(1) Disconnect hose attaching bolt (compressor side).

(2) Disconnect hose attaching bolt (condenser side).

CAUTION:

Plug the opening to prevent foreign matter from getting in.

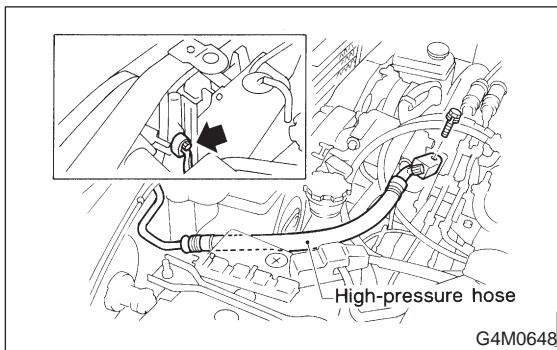

- 5) Installation is in the reverse order of removal.
6) Charge refrigerant. <Ref. to 4-7 [W700].>

17. Relay and Fuse

A: LOCATION

Relays used with A/C system are located as shown in figure.

- A/C relay
- Sub fan (condenser fan) relay
- Fuses (10 A and 20 A)

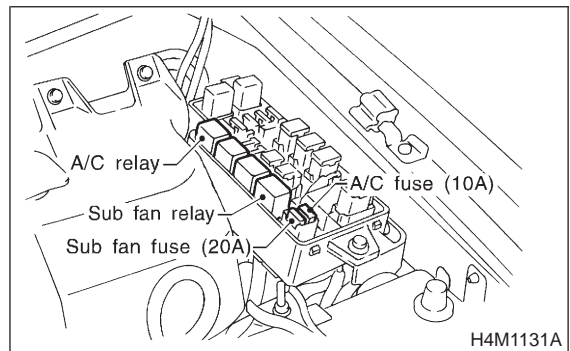

- A/C cut relay

A/C cut relay is attached by a bolt to top of front suspension bracket (RH) via a bracket.

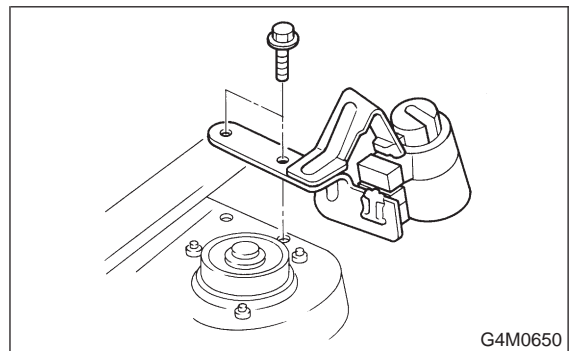

B: INSPECTION

1) Check conduction with a circuit tester (ohm range) according to the following table in figure.

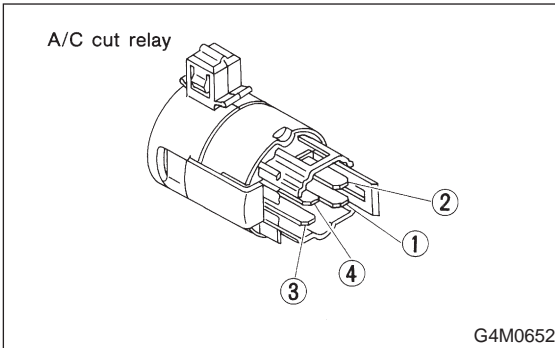
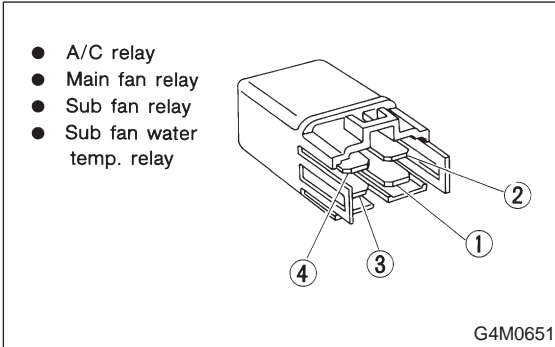

2) Replace relays which do not meet specifications.

A/C relay Main fan relay Sub fan relay Sub fan water temp. relay	A/C cut relay
About 100Ω between ① and ②	About 120Ω between ① and ②
∞Ω between ③ and ④	∞Ω between ③ and ④

G4M0653