

## 8. Lateral Link

### A: REMOVAL

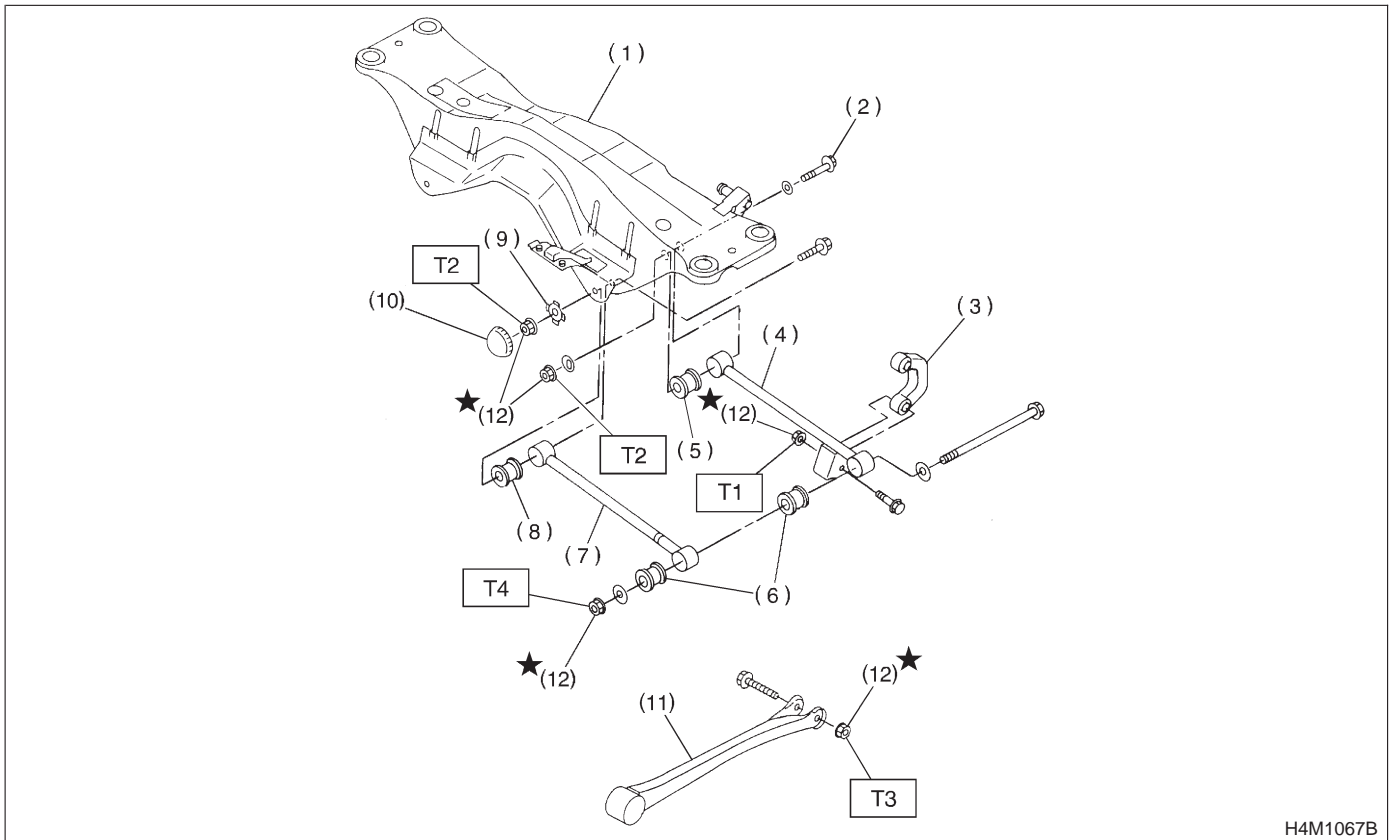

H4M1067B

- |                        |                       |
|------------------------|-----------------------|
| (1) Crossmember        | (8) Bushing (B)       |
| (2) Adjusting bolt     | (9) Washer            |
| (3) Stabilizer link    | (10) Cap              |
| (4) Rear lateral link  | (11) Trailing link    |
| (5) Bushing (C)        | (12) Self-locking nut |
| (6) Bushing (A)        |                       |
| (7) Front lateral link |                       |

**Tightening torque: N-m (kg-m, ft-lb)**

**T1: 44±6 (4.5±0.6, 32.5±4.3)**

**T2: 98±15 (10.0±1.5, 72±11)**

**T3: 113±15 (11.5±1.5, 83±11)**

**T4: 137±20 (14.0±2.0, 101±14)**

1) Loosen wheel nuts. Jack-up vehicle and remove wheel.

2) Remove stabilizers.

3) ( Models equipped with ABS )

Remove ABS sensor harness from trailing link.

4) Remove bolts which secure lateral link assembly to rear housing.

**CAUTION:**

**Discard old self-locking nut. Replace with a new one.**

5) Remove bolts which secure trailing link assembly to rear housing.

**CAUTION:**

**Discard old self-locking nut. Replace with a new one.**

6) Remove DOJ from rear differential using ST. (2200 cc MT model)

ST 28099PA100 DRIVE SHAFT REMOVER

**CAUTION:**

**Do not remove circlip attached to inside of differential.**

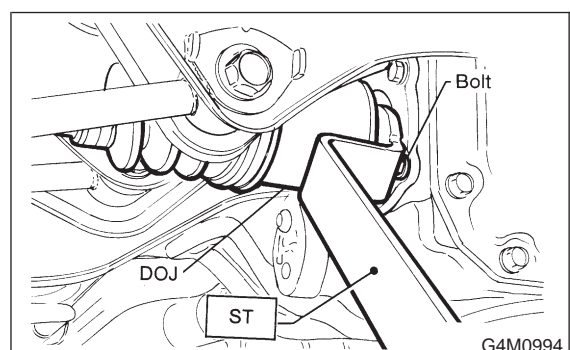

G4M0994

**CAUTION:**

Be careful not to damage side bearing retainer. Always use bolt as shown in figure, as supporting point for ST during removal.

ST 28099PA100 DRIVE SHAFT REMOVER

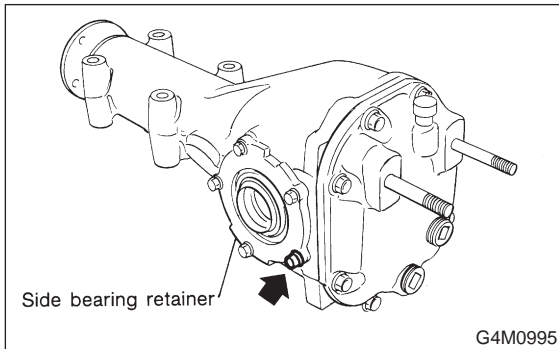

7) Remove DOJ from rear differential using tire lever. (Except 2200 cc MT model)

**NOTE:**

The side spline shaft circlip comes out together with the shaft.

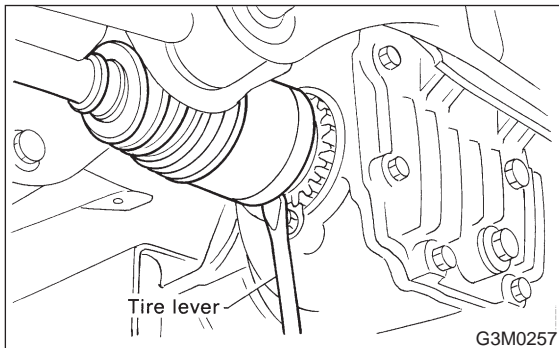

**CAUTION:**

When removing the DOJ from the rear differential, fit tire lever to the bolt as shown in figure so as not to damage the axle shaft holder.

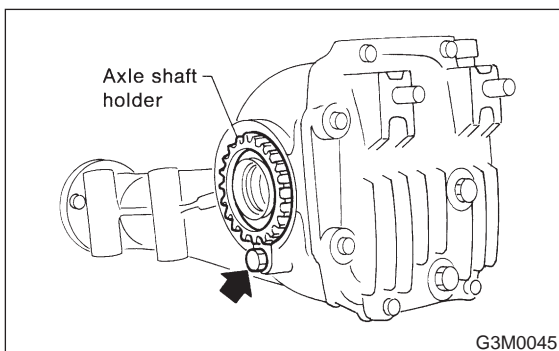

8) Scribe an alignment mark on rear lateral link adjusting bolt and crossmember.

9) Remove outer lateral link bolt securing lateral link to housing.

10) Remove bolts securing front and rear lateral links to crossmember, detach lateral links.

**CAUTION:**

To loosen adjusting bolt, always loosen nut while holding the head of adjusting bolt.

**B: DISASSEMBLY**

Using ST, press bushing out of place.

**NOTE:**

- Using the following figure as a guide, verify the type of bushings.
- Select ST according to the type of bushings used.

Bushing	INSTALLER & REMOVER SET
Bushing A	927700000
Bushing B	927690000
Bushing C	927700000

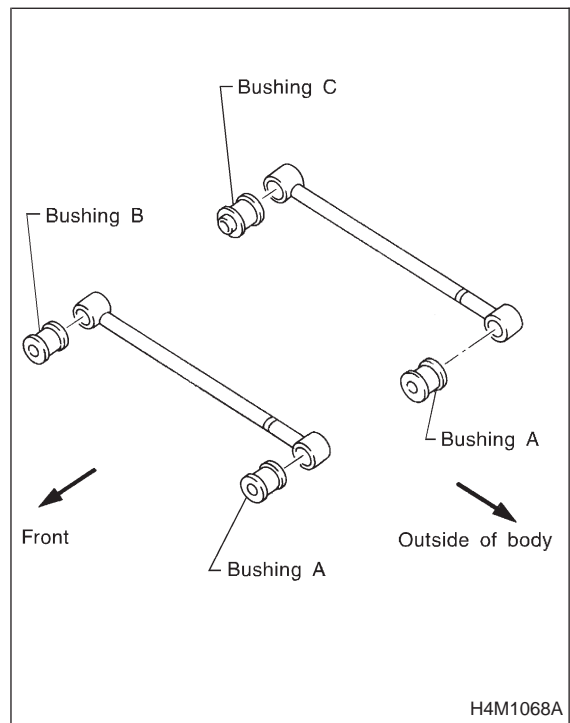

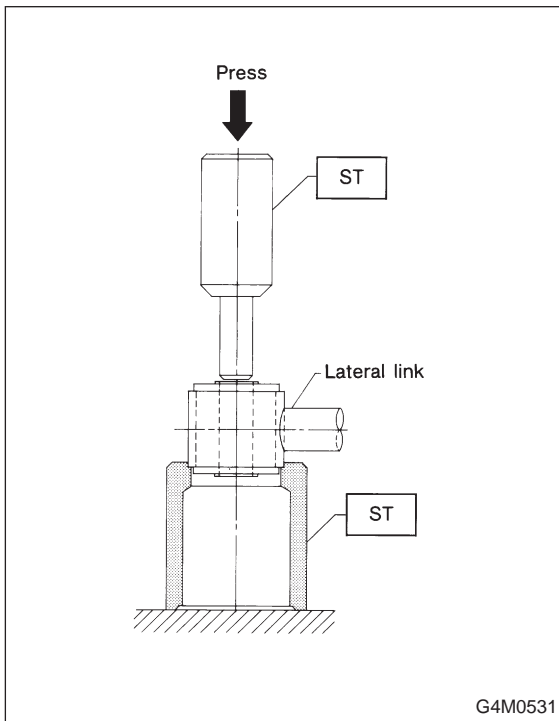

**C: INSPECTION**

Visually check lateral links for damage or bends.

**D: ASSEMBLY**

1) Using ST, press bushing into place.

**CAUTION:**

Select ST according to the type of bushings used.

**NOTE:**

- Use the same ST as that used during disassembly.
- If it is difficult to press bushing into trailing link, apply water-diluted TIRE LUBE to the inner surface of ST as a lubricant.

**Specified lubricant:**

**TIRE LUBE : water = 1 : 3**

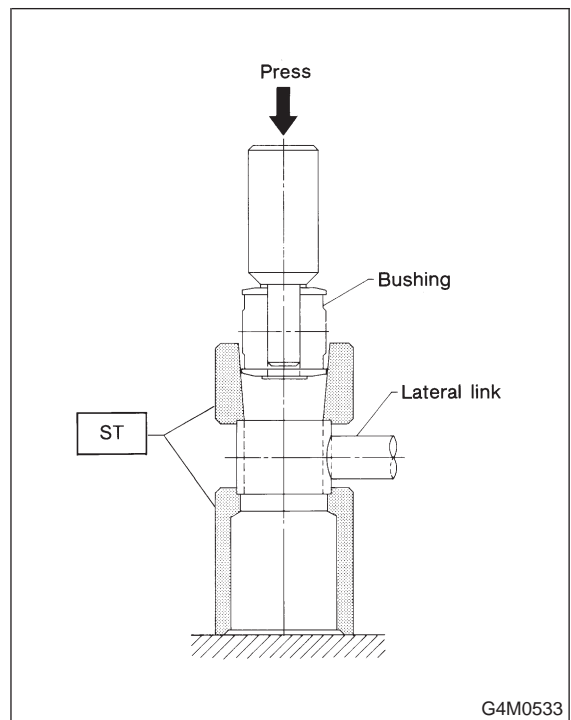

2) Press ST plunger until bushing flange protrudes beyond lateral link.

NOTE:

Use the same ST as that used during disassembly.

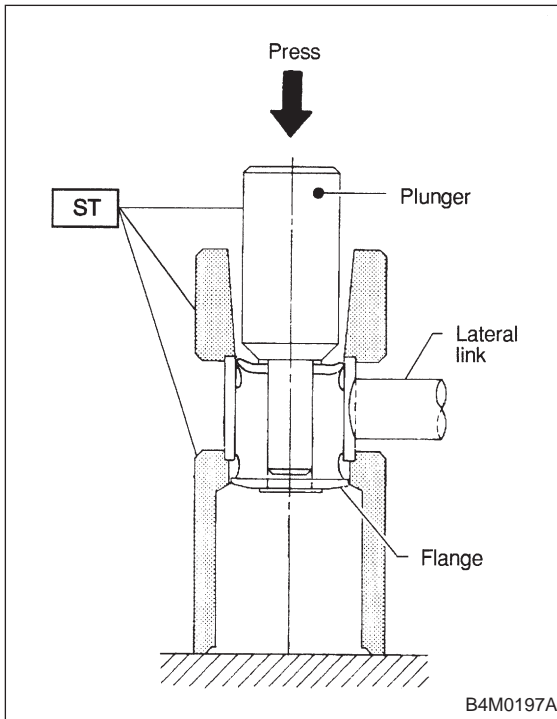

3) Turn lateral link upside down. Press ST plunger in the opposite direction that outlined in the former procedure until bushing is correctly positioned in trailing link.

NOTE:

Use the same ST as that used during disassembly.

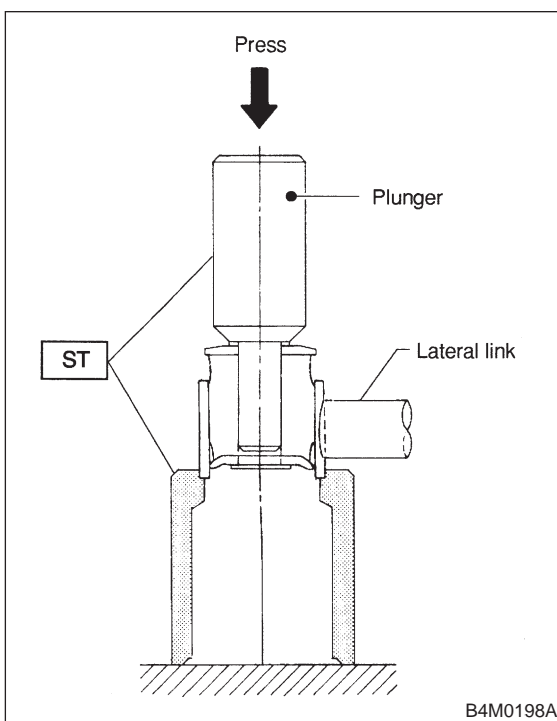

## E: INSTALLATION

To install, reverse removal procedures, observing the following instructions.

● Installation of DOJ to differential: <Ref. to 4-2 [W3E2].>

### CAUTION:

- Do not allow DOJ splines to damage side oil seal.
- Always tighten rubber bushing location when wheels are in full contact with the ground and vehicle is curb weight.
- Tighten nut when installing adjusting bolt.
- Replace self-locking nut and DOJ circlip with new ones.

### NOTE:

- Lateral link washers for AWD model can be identified by the following color: Gold (AWD model)
- Check wheel alignment and adjust if necessary.