

## 23. Dropping Resistor

### A: REMOVAL AND INSTALLATION

- 1) Disconnect battery ground cable.

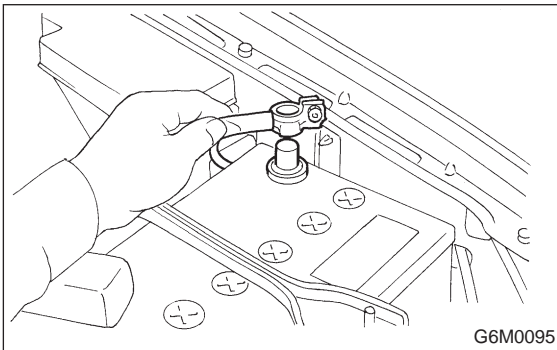

- 2) Remove air intake duct. <Ref. to 2-7 [W1A0].>
- 3) Disconnect connector from dropping resistor.
- 4) Remove dropping resistor from bracket.

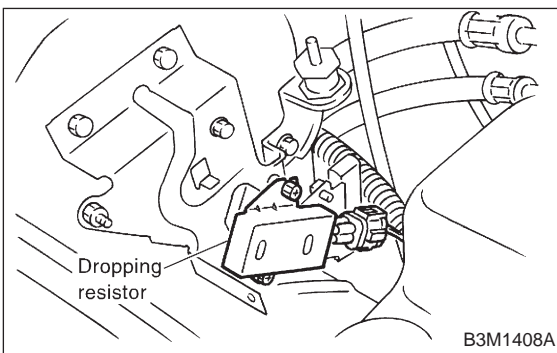

- 5) Installation is in the reverse order of removal.

**Tightening torque:**

**$6.4 \pm 0.5 \text{ N}\cdot\text{m}$  ( $0.65 \pm 0.05 \text{ kg}\cdot\text{m}$ ,  $4.7 \pm 0.4 \text{ ft}\cdot\text{lb}$ )**

